

FORM B – BUILDING

Assessor's Number USGS Quad Area(s) Form Number

MASSACHUSETTS HISTORICAL COMMISSION
MASSACHUSETTS ARCHIVES BUILDING
220 MORRISSEY BOULEVARD
BOSTON, MASSACHUSETTS 02125

| | | | |
|--------|----------|--|---------|
| 73-007 | Sandwich | | SDW.209 |
|--------|----------|--|---------|

Town/City: Sandwich

Place: (*neighborhood or village*): Town Hall Square
Historic District

Address: 10 Grove Street

Historic Name: Dexter – Pope House

Uses: Present: Single Family Dwelling House

Original: Single Family Dwelling House

Date of Construction: 1699

Source: Assessor

Style/Form: Colonial

Architect/Builder:

Exterior Material:

Foundation: stone

Wall/Trim: clapboard, shingles

Roof: gable

Outbuildings/Secondary Structures:

Major Alterations (*with dates*):

Condition: very good

Moved: no yes **Date:**

Acreage: .94

Setting: The Town Hall Square Historic District in Sandwich is the site of the first settlement on Cape Cod. Grove Street, containing a number of seventeenth, eighteenth and nineteenth century buildings, with no modern intrusions, faces Shawme Pond. Farther south is the first town cemetery situated on a small tree-shaded peninsula extending into the pond.

Photograph



Locus Map

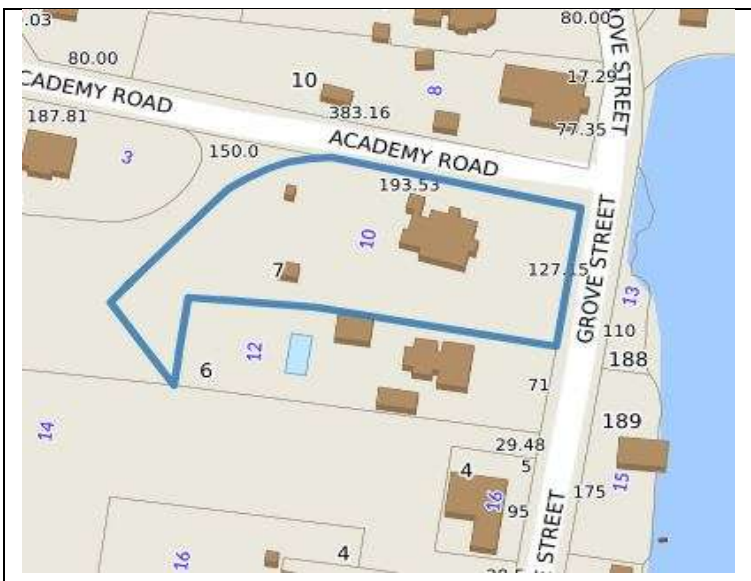

Recorded by: D. Bayley

Organization: Sandwich Historical Commission

Date (*month / year*): Aug / 2011

Recommended for listing in the National Register of Historic Places.

If checked, you must attach a completed National Register Criteria Statement form.

Use as much space as necessary to complete the following entries, allowing text to flow onto additional continuation sheets.

ARCHITECTURAL DESCRIPTION:

Describe architectural features. Evaluate the characteristics of this building in terms of other buildings within the community.

#10 Grove St. is a full Colonial building rising 2 1/2-stories to a gable roof with a central chimney. The entrance, centered in a 5-bay facade, has sidelights and an open, gabled portico.

Grove Street, contains a number of seventeenth, eighteenth and nineteenth century buildings, with no modern intrusions. The neighboring Newcomb Tavern (SDW.210), c. 1703 is also a full Colonial building which, with the subject Dexter – Pope house, greatly enhances the streetscape. The Lemuel Pope House (SDW.207), a large shingled Georgian double house built in 1794, faces north, presenting its gable end to the street.

HISTORICAL NARRATIVE

Discuss the history of the building. Explain its associations with local (or state) history. Include uses of the building, and the role(s) the owners/occupants played within the community.

The #10 Grove Street story starts with Seth Pope. Known as “Seth the Trader” he is part of Sandwich legend. Seth came to town in 1670 reportedly with a backpack containing needles, thread and other portable peddling items. Through some conflict with the selectmen, he was ordered out of town. He left with an irritated promise to come back and buy up the town. True to his promise, Seth Pope came back in 1699 and bought the town grist mill from John Dexter. Seth also bought up lands along Grove Street beyond Academy Road and a house at #10 Grove from Dexter referred to as “my now house.” In 1709, his younger son, Seth Jr. came to Sandwich and in 1710 married Hannah Bourne, the sister of his brother's wife. They started what became the big colonial house at 10 Grove Street. Seth's father placed Seth Jr. in charge of the family-owned grist mill as well as a fulling mill and weave shop. Seth, Jr. died in 1744. The house stayed in the Pope family and in 1762 was divided into a 2-family home.

In 1841, half of the house was sold to William H. Russell. He bought the other half in 1845. Upon William's death in 1848 the house went to his sister Lydia (married to Captain Nelson Crocker) and to his brother Dr. Henry Russell (married to Mary Mitchell of Nantucket). In 1880 Dr. Russell was the sole owner but Captain Laban Crocker, the last miller, also lived there.

#10 Grove St. came to be known in town as the “Russell House.”

BIBLIOGRAPHY and/or REFERENCES

Lovell, Russell, *Sandwich, A Cape Cod Town*

Massachusetts Marriages, 1633-1850

Pope, Franklin Leonard, *Genealogy of Thomas Pope and Some of His Descendants*, Boston, 1888.

Sandwich Town Archives

Sandwich. Area A. Sandwich Center Village SDW.A

Town Hall Square Historic District SDW.S
Christine Boulding, Assistant Survey Director, and Shirley Cross
August, 1975
Massachusetts Historical Commission
40 Beacon Street
Boston, Massachusetts 02108

Town Hall Square Historic District (2010) SDW.X